

# **McHale** *ENGINEERING*



QUALITY

I.S. EN ISO 9001:2008

**NSAI Certified**



## **Blockcutter Spare Parts Book**

McHale Engineering,  
Castlebar Rd, Ballinrobe,  
Co. Mayo, Ireland.  
Tel: +353 94 9520300  
Fax: +353 94 9520356  
Email: [sales@mchale.net](mailto:sales@mchale.net)  
Website: [www.mchale.net](http://www.mchale.net)

---

[www.edanex.pl](http://www.edanex.pl)

This page is intentionally left blank

---

## Introduction

---

The **McHale Blockcutter** which you have purchased has been developed through years of constant research and development. Given proper care and attention the **Blockcutter** will give years of reliable and dependable performance. However it is important that the operators manual is read and fully understood to achieve this, **before** the machine is operated. As part of this philosophy it is vital to use only **genuine McHale** replacement parts, as these are manufactured to the same high standard as the original machine. These may be obtained through your **McHale** dealer.

If any part of this manual is not fully understood, please contact your **McHale** dealer who will be able to answer any questions or queries that you might have. It is important to quote the machine serial number when requiring spare parts or technical assistance. Space is provided below to record the machine details:

<b>Serial number:</b>	
<b>Year of manufacture:</b>	
<b>Date of delivery:</b>	

If you require further copies of this spare parts manual please  
quote part number CLT00351

**Note:** Parts described as left and right are done so according to the direction that the machine normally travels in.

**Note:** Due to a policy of continuous product development and improvement *McHale Engineering* reserve the right to alter machine specifications without prior notice.

---

## Contents

---

Section	Document No	Section	Document No
<b>Blockcutter</b>			
Shear grab 1.15M (309)	SPD00309		
Shear grab 1.3M (310)	SPD00310		
Shear grab 1.6M (311)	SPD00311		
Shear grab 2.0M (312)	SPD00312		
Push-off attachment (313)	SPD00313		
High lift frame (314)	SPD00314		
Decals (700)	SPD00700		

[www.edanex.pl](http://www.edanex.pl)

---

[www.edanex.pl](http://www.edanex.pl)

This page is intentionally left blank

**Shear grab 1.15M (309)**

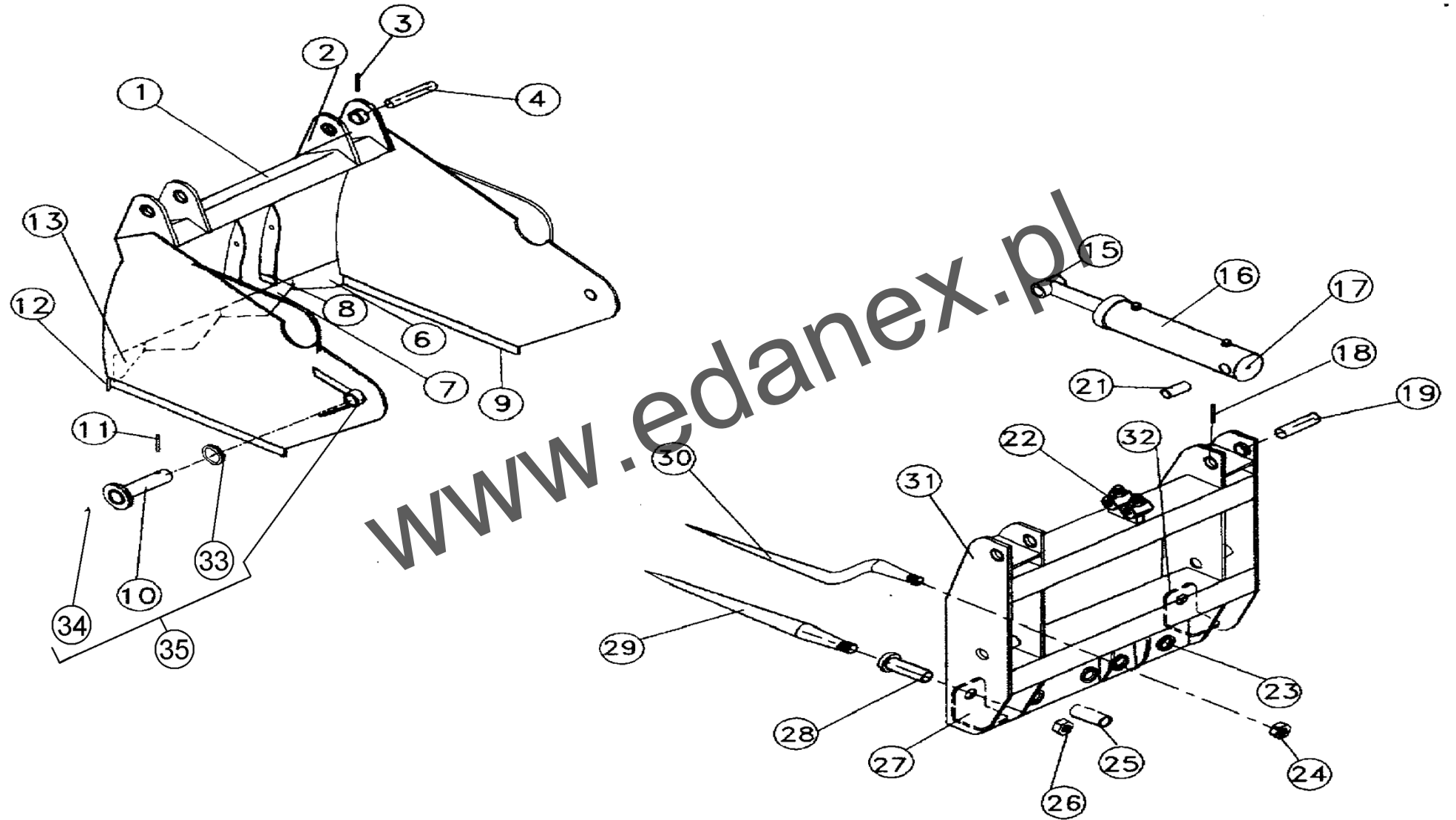

No.	Part No	Description	Qty
1	ASG00007	SHEAR GRAB FRONT 1.15M	1
2	ASG00002	SHEAR GRAB RAM BRACKET	2
2	ASG00001	SHEAR GRAB RAM BRACKET 8MM C/H	2
3	CFA00010	ROLL PIN 8X50 Z/P	2
4	CMH00199	PIN 30X170&8MM C.HOLE Z/P	2
6	CKN00006	KNIFE CORNER R/H 3 9	1
7	CKN00002	KNIFE SHEAR GRAB CENTRE POINT	4
8	ASG00016	KNIFE FOR INSIDE FRONT PLATE	2
9	CKN00007	KNIFE SHEAR GRAB SIDE KN	2
10	CMH00198	PIN 45X215&11MM C.HOLE	2
<i>FROM SERIAL NO. 506425 ONWARDS. (FOR OLDER SERIAL NOS USE ITEM 35 REPAIR-KIT)</i>			
11	CFA00110	ROLL PIN 12X60	2
12	CMH00201	SHEAR GRAB END SPIKE 25X180	2
13	CKN00005	KNIFE CORNER L/H 3 9	1
15	CRA10018	RAM ROD SHEAR GRAB 80mm	2
16	CRA00018	RAM SHEAR GRAB 80mm STD	2
16	CSE00020	SEAL KIT RAM 80mm	2
17	CFA00118	GREASE NIPPLE M8X1.25 STRAIGHT	2
18	CFA00010	ROLL PIN 8X50 Z/P	2
19	ASG00041	PIN PIVOT RAM TO BACK FRAME SG	2
21	CBR00007	BEARING GLACIER PM 30X34X25	8
22	CHY00014	3/8BSP TEE PIECE M/M/M	2
23	ASG00012	SHEAR GRAB BEAM 1.15M	1
24	CFA00238	TINE NUT M22 STONE FORK	6
25	CMH00011	BUSH TINE 5/8	6
26	CFA00211	TINE NUT M28 STONE FORK	2
27	ASG00004	SHEAR GRAB WEAR PLATE L/H	1
28	CMH00012	BUSH TINE 20mm COLAR	2
29	CTN00004	TINE 32 STONE FORK SHW	2
30	CTN00006	TINE 32 CRANKED SHW	6
31	ASG00018	SHEAR GRAB BACK FRAME 1.15M	1
32	ASG00005	SHEAR GRAB WEAR PLATE R/H	1
33	CBR00292	BEARING GLACIER	2
34	CFA00118	GREASE NIPPLE M8X1.25 STRAIGHT	2
35	ASG00068	PIVOT BUSHING REPAIR KIT	2
<i>UP TO SERIAL NO 506424 (INCLUDES ITEMS 10, 33, 34 + WELD-IN PIVOT-BOSS IN ITEM 1)</i>			

No.	Part No	Description	Qty
-----	---------	-------------	-----

www.edanex.pl

**Shear grab 1.3M (310)**

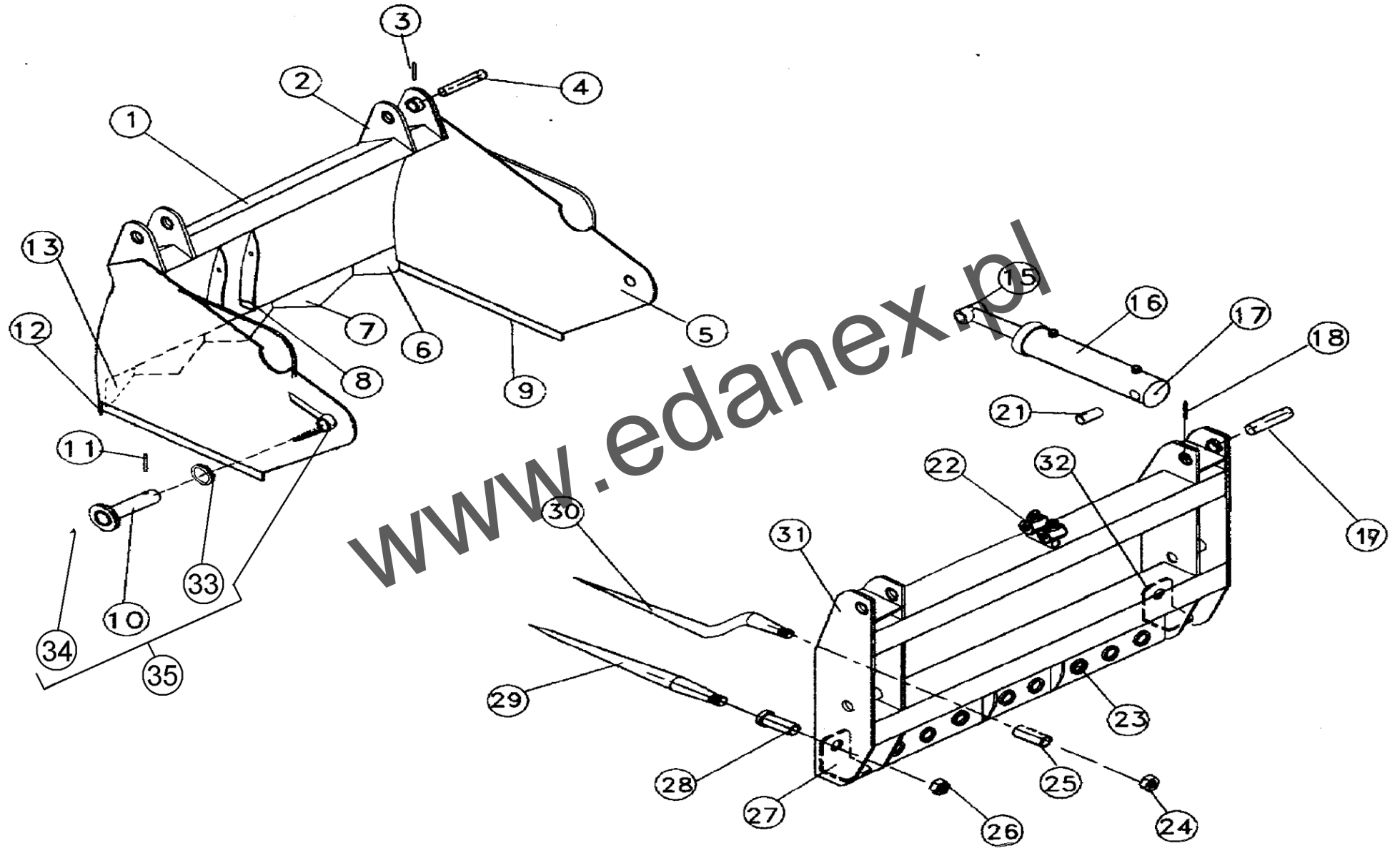



No.	Part No	Description	Qty
1	ASG00008	SHEAR GRAB FRONT 1.3M	1
2	ASG00002	SHEAR GRAB RAM BRACKET	2
2	ASG00001	SHEAR GRAB RAM BRACKET 8MM C/H	2
3	CFA00010	ROLL PIN 8X50 Z/P	2
4	CMH00199	PIN 30X170&8MM C.HOLE Z/P	2
6	CKN00004	KNIFE SHEAR GRAB CORNER R/H	1
7	CKN00002	KNIFE SHEAR GRAB CENTRE POINT	3
8	ASG00016	KNIFE FOR INSIDE FRONT PLATE	2
9	CKN00007	KNIFE SHEAR GRAB SIDE KN	2
10	CMH00198	PIN 45X215&11MM C.HOLE	2
<i>FROM SERIAL NO. 506425 ONWARDS. (FOR OLDER SERIAL NOS USE ITEM 35 REPAIR-KIT)</i>			
11	CFA00110	ROLL PIN 12X60	2
12	CMH00201	SHEAR GRAB END SPIKE 25X180	2
13	CKN00003	KNIFE SHEAR GRAB CORNER L/H	1
15	CRA10015	RAM ROD SHEAR GRAB 90mm	2
16	CRA00015	RAM SHEAR GRAB 90mm STD	2
16	CSE00015	SEAL KIT RAM 90mm SHEAR GRAB	2
17	CFA00118	GREASE NIPPLE M8X1.25 STRAIGHT	2
18	CFA00010	ROLL PIN 8X50 Z/P	2
19	ASG00041	PIN PIVOT RAM TO BACK FRAME SG	2
21	CBR00007	BEARING GLACIER PM 30X34X25	8
22	CHY00014	3/8"BSP TEE PIECE M/M/M	2
23	ASG00013	SHEAR GRAB BEAM 1.3M	1
24	CFA00238	TINE NUT M22 STONE FORK	8
25	CMH00011	BUSH TINE 1" 5/8	8
26	CFA00211	TINE NUT M28 STONE FORK	2
27	ASG00004	SHEAR GRAB WEAR PLATE L/H	1
28	CMH00012	BUSH TINE 20mm COLAR	2
29	CTN00004	TINE 32" STONE FORK SHW	2
30	CTN00006	TINE 32" CRANKED SHW	8
31	ASG00019	SHEAR GRAB BACK FRAME 1.3M	1
32	ASG00005	SHEAR GRAB WEAR PLATE R/H	1
33	CBR00292	BEARING GLACIER 1/4" SY 2"	2
34	CFA00118	GREASE NIPPLE M8X1.25 STRAIGHT	2
35	ASG00068	PIVOT BUSHING REPAIR KIT	2
<i>UP TO SERIAL NO. 506424 (INCLUDES ITEMS 10, 33, 34 + WELD-IN PIVOT-BOSS IN ITEM 1)</i>			

No.	Part No	Description	Qty
-----	---------	-------------	-----

www.edanex.pl

**Shear grab 1.6M (311)**

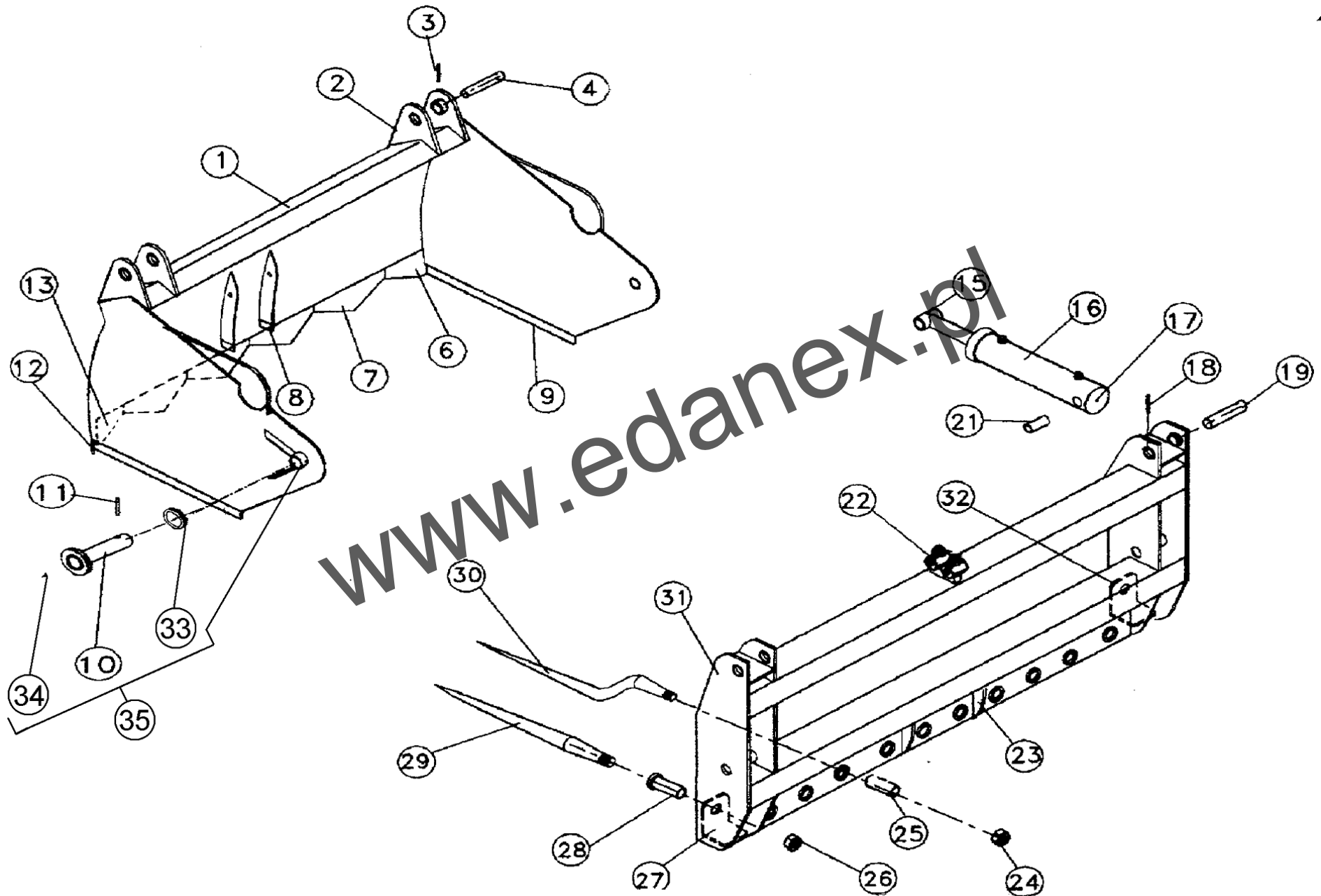

No.	Part No	Description	Qty
1	ASG00009	SHEAR GRAB FRONT 1.6M	1
2	ASG00002	SHEAR GRAB RAM BRACKET	2
2	ASG00001	SHEAR GRAB RAM BRACKET 8MM C/H	2
3	CFA00010	ROLL PIN 8X50 Z/P	2
4	CMH00199	PIN 30X170&8MM C.HOLE Z/P	2
6	CKN00004	KNIFE SHEAR GRAB CORNER R/H	1
7	CKN00002	KNIFE SHEAR GRAB CENTRE POINT	4
8	ASG00016	KNIFE FOR INSIDE FRONT PLATE	2
9	CKN00007	KNIFE SHEAR GRAB SIDE KN	2
10	CMH00198	PIN 45X215&11MM C.HOLE	2
<i>FROM SERIAL NO. 506425 ONWARDS. (FOR OLDER SERIAL NOS USE ITEM 35 REPAIR-KIT)</i>			
11	CFA00110	ROLL PIN 12X60	2
12	CMH00201	SHEAR GRAB END SPIKE 25X180	2
13	CKN00003	KNIFE SHEAR GRAB CORNER L/H	1
15	CRA10015	RAM ROD SHEAR GRAB 90mm	2
16	CRA00015	RAM SHEAR GRAB 90mm STD	2
16	CSE00015	SEAL KIT RAM 90mm SHEAR GRAB	2
17	CFA00118	GREASE NIPPLE M8X1.25 STRAIGHT	2
18	CFA00010	ROLL PIN 8X50 Z/P	2
19	ASG00041	PIN PIVOT RAM TO BACK FRAME SG	2
21	CBR00007	BEARING GLACIER PM 30X34X25	8
22	CHY00014	3/8"BSP TEE PIECE M/M/M	2
23	ASG00014	SHEAR GRAB BEAM 1.6M	1
24	CFA00238	TINE NUT M22 STONE FORK	10
25	CMH00011	BUSH TINE 1" 5/8	10
26	CFA00211	TINE NUT M28 STONE FORK	2
27	ASG00004	SHEAR GRAB WEAR PLATE L/H	1
28	CMH00012	BUSH TINE 20mm COLAR	2
29	CTN00004	TINE 32" STONE FORK SHW	2
30	CTN00006	TINE 32" CRANKED SHW	10
31	ASG00020	SHEAR GRAB BACK FRAME 1.6M	1
32	ASG00005	SHEAR GRAB WEAR PLATE R/H	1
33	CBR00292	BEARING GLACIER 1/4" SY 2"	2
34	CFA00118	GREASE NIPPLE M8X1.25 STRAIGHT	2
35	ASG00068	PIVOT BUSHING REPAIR KIT	2
<i>UP TO SERIAL NO. 506424 (INCLUDES ITEMS 10, 33, 34 + WELD-IN PIVOT-BOSS IN ITEM 1)</i>			

No.	Part No	Description	Qty
-----	---------	-------------	-----

www.edanex.pl

**Shear grab 2.0M (312)**

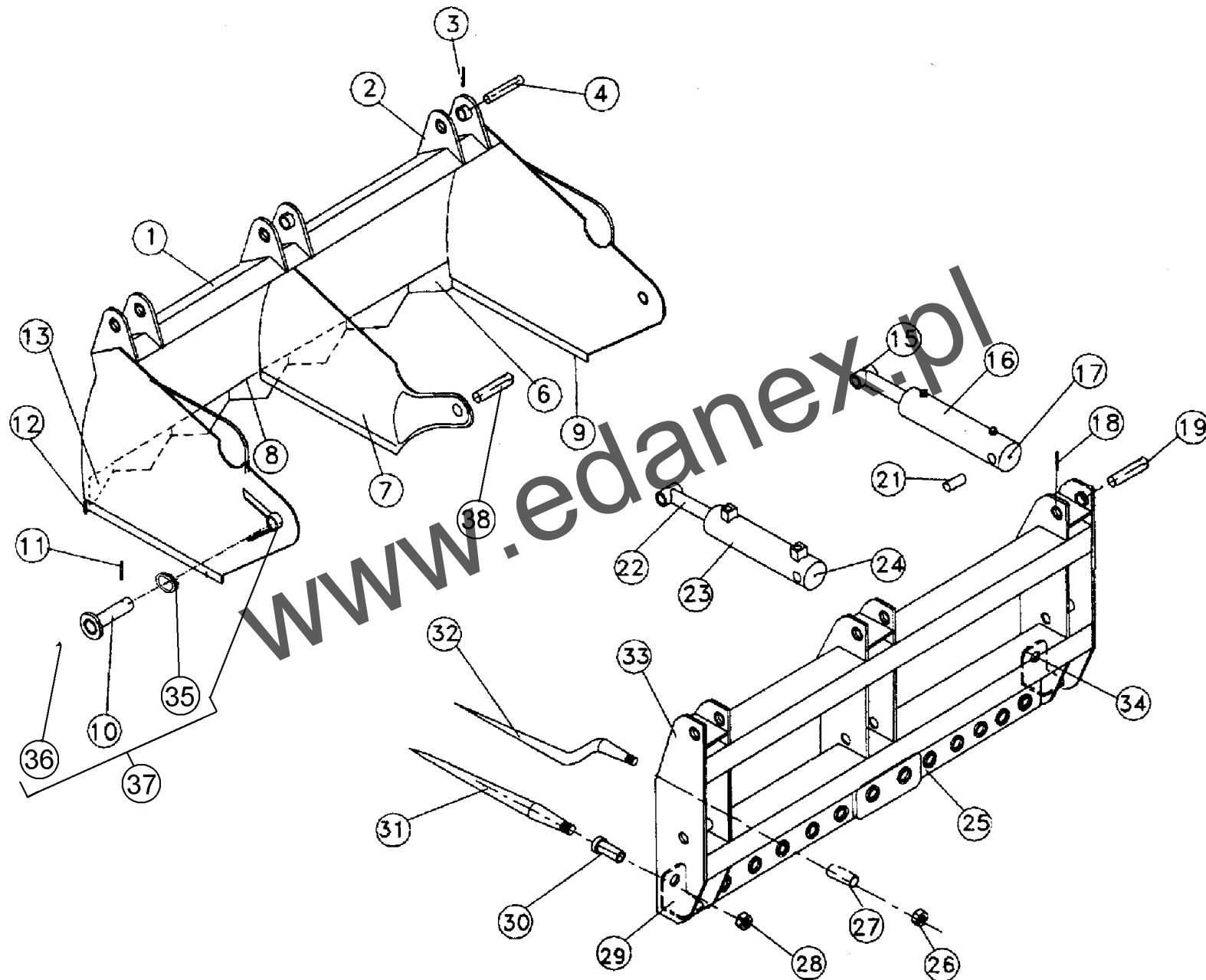

No.	Part No	Description	Qty
1	ASG00010	SHEAR GRAB FRONT 2.0M	1
2	ASG00002	SHEAR GRAB RAM BRACKET	3
2	ASG00001	SHEAR GRAB RAM BRACKET 8MM C/H	3
3	CFA00010	ROLL PIN 8X50 Z/P	3
4	CMH00199	PIN 30X170&8MM C.HOLE Z/P	3
6	CKN00004	KNIFE SHEAR GRAB CORNER R/H	1
7	ASG00022	CENTRE PLATE FOR 2.0M	1
8	CKN00002	KNIFE SHEAR GRAB CENTRE POINT	5
9	CKN00007	KNIFE SHEAR GRAB SIDE KN	3
10	CMH00198	PIN 45X215&11MM C.HOLE	2
<i>FROM SERIAL NO. 506425 ONWARDS. (FOR OLDER SERIAL NOs USE ITEM 37 REPAIR-KIT)</i>			
11	CFA00110	ROLL PIN 12X60	3
12	CMH00201	SHEAR GRAB END SPIKE 25X180	2
13	CKN00003	KNIFE SHEAR GRAB CORNER L/H	1
15	CRA10015	RAM ROD SHEAR GRAB 90mm	2
16	CRA00015	RAM SHEAR GRAB 90mm STD	2
16	CSE00015	SEAL KIT RAM 90mm SHEAR GRAB	2
17	CFA00118	GREASE NIPPLE M8X1.25 STRAIGHT	2
18	CFA00010	ROLL PIN 8X50 Z/P	3
19	ASG00041	PIN PIVOT RAM TO BACK FRAME SG	3
21	CBR00007	BEARING GLACIER PM 30X34X25	2
22	CRA01023	RAM ROD 90MM SQ PORT SG OVAL HOLE	1
23	CRA00023	RAM SHEAR GRAB 90mm SQ/PORTS	1
23	CSE00015	SEAL KIT 90MM	1
24	CFA00118	GREASE NIPPLE M8X1.25 STRAIGHT	1
25	ASG00015	SHEAR GRAB BEAM 2.0M	1
26	CFA00238	TINE NUT M22 STONE FORK	10
27	CMH00011	BUSH TINE 1" 5/8	10
28	CFA00211	TINE NUT M28 STONE FORK	4
29	ASG00004	SHEAR GRAB WEAR PLATE L/H	1
30	CMH00012	BUSH TINE 20mm COLAR	4
31	CTN00004	TINE 32" STONE FORK SHW	4
32	CTN00006	TINE 32" CRANKED SHW	10
33	ASG00021	SHEAR GRAB BACK FRAME 2.0M	1
34	ASG00005	SHEAR GRAB WEAR PLATE R/H	1
35	CBR00292	BEARING GLACIER 1/4" SY 2"	2
36	CFA00118	GREASE NIPPLE M8X1.25 STRAIGHT	2
37	ASG00068	PIVOT BUSHING REPAIR KIT	2
<i>UP TO SERIAL NO. 506424 (INCLUDES ITEMS 10, 35, 36 + WELD-IN PIVOT-BOSS IN ITEM 1)</i>			
38	ASG00040	PIN PIVOT CENTRE PLATE 2M SG	1

No.	Part No	Description	Qty
-----	---------	-------------	-----

www.edanex.pl

**Push-off attachment (313)**

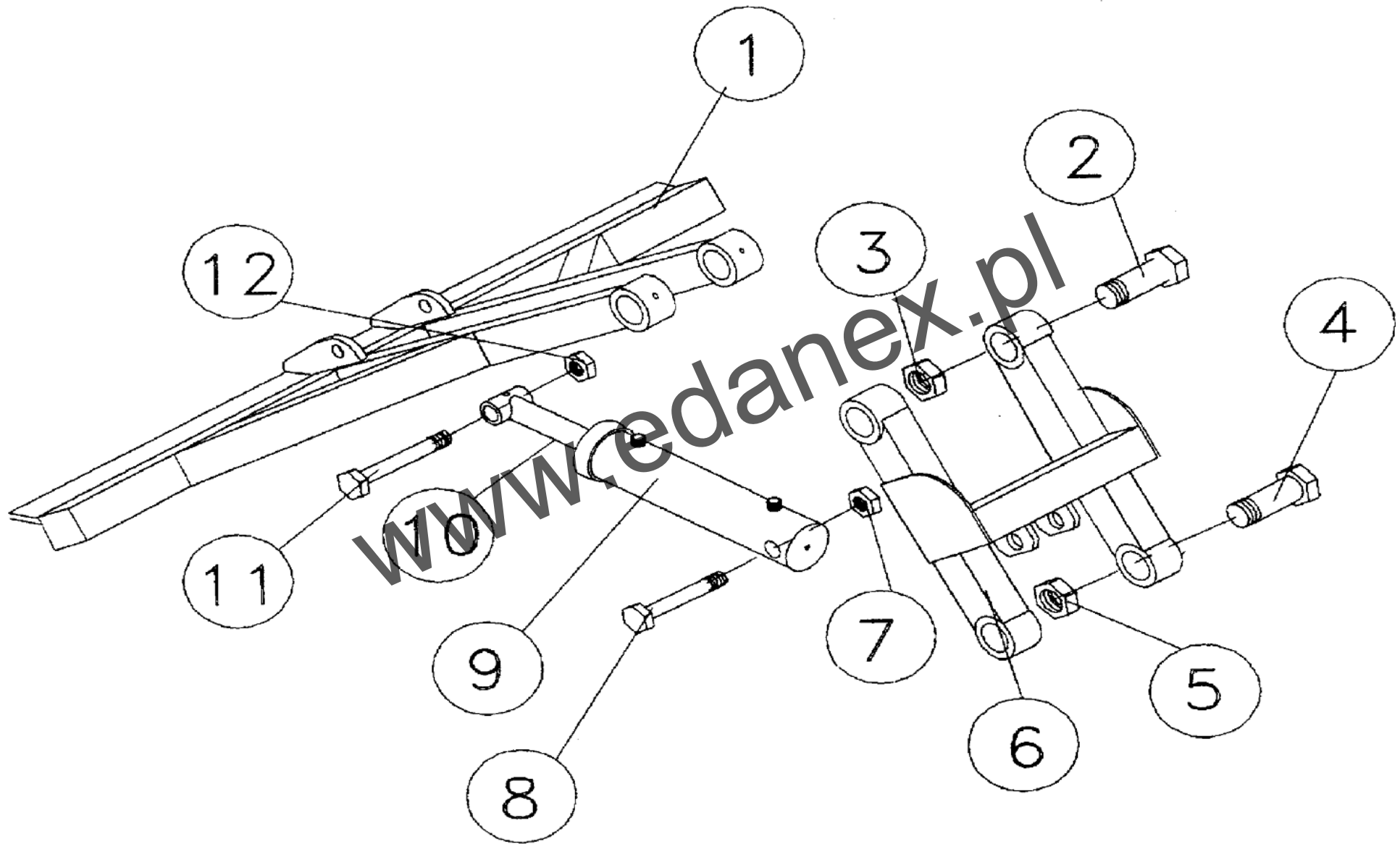

No.	Part No	Description	Qty
1	QSG00019	PUSH OFF 1.0M COMPLETE	1
1	QSG00020	PUSH OFF 1.15M COMPLETE	1
1	QSG00021	PUSH OFF 1.3M COMPLETE	1
1	QSG00022	PUSH OFF 1.6M COMPLETE	1
1	QSG00023	PUSH OFF 2.0M COMPLETE	1
1	ASG00023	PUSH OFF SLIDE 1.0M	1
1	ASG00024	PUSH OFF SLIDE 1.15M	1
1	ASG00026	PUSH OFF SLIDE 1.3M	1
1	ASG00027	PUSH OFF SLIDE 1.6M	1
1	ASG00028	PUSH OFF SLIDE 2.0M	1
2	CFA00209	BOLT M16X120 Z/P	2
3	CFA00128	NUT M16 NYLOC	2
4	CFA00063	BOLT M16X90 Z/P	2
5	CFA00128	NUT M16 NYLOC	2
6	ASG00029	PUSH OFF JOINING ATTACHMENT	1
7	CFA00128	NUT M16 NYLOC	1
8	CFA00040	BOLT M16X100 Z/P	1
9	CRA00029	RAM SHEAR GRAB PUSH OFF	1
9	CSE00029	SEAL KIT PUSH OFF RAM	1
10	CRA10029	RAM ROD PUSH OFF	1
11	CFA00209	BOLT M16X120 Z/P	1
12	CFA00128	NUT M16 NYLOC	1

No.	Part No	Description	Qty
-----	---------	-------------	-----

www.edanex.pl

**High lift frame (314)**

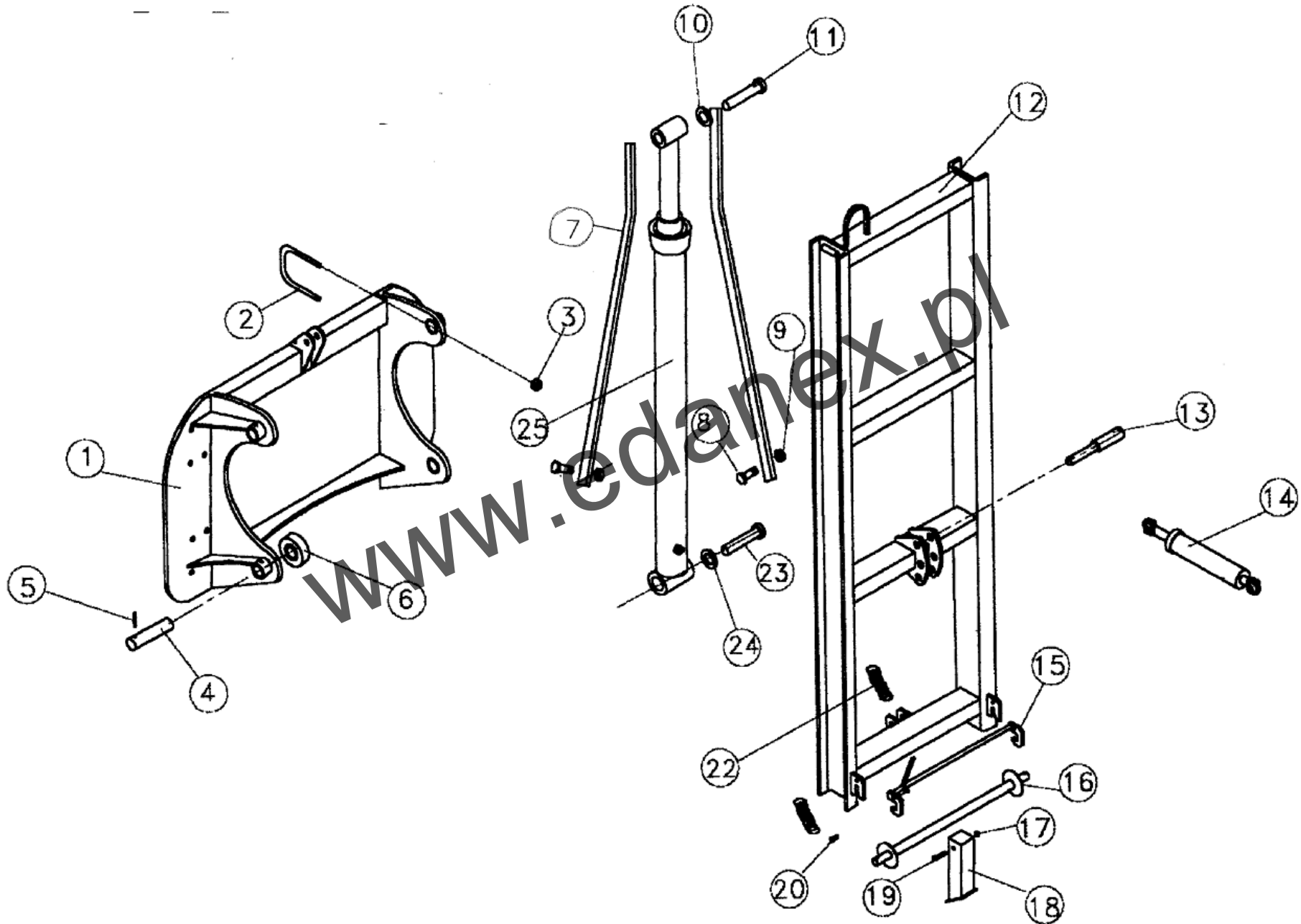



No.	Part No	Description	Qty
1	ASG00043	ADAPTOR BACK (SG 1.15M,1.3M,1.6M)	1
1	ASG00044	ADAPTOR BACK (SG 2.0M)	1
2	CFA00039	U BOLT M16X80X80 Z/P (FOR QSG10004)	8
2	CFA00301	U BOLT M20X100X100 Z/P(FOR QSG10005)	8
3	CFA00128	NUT M16 NYLOC (FOR QSG10004)	16
3	CFA00129	M20 NYLOC (FOR QSG10005)	16
4	CMH00200	PIN 30X115&8MM C.HOLE Z/P	4
5	CFA00010	ROLL PIN 8X50 Z/P	4
6	CMH00044	ROLLER 30X91X57 CHAMFERED	4
7	ASG00031	STABLISING BAR HLF 2.0	2
7	ASG00032	STABLISING BAR HLF 2.25	2
7	ASG00033	STABLISING BAR HLF 2.5	2
7	ASG00030	STABILISING BAR HLF (SG 1.0M)	2
8	CFA00278	BOLT M20X50 Z/P	2
9	CFA00129	M20 NYLOC	2
10	CFA00136	WASHER FLAT 3/4" Z/P	1
11	CMH00037	TOPLINK PIN 3/4" Z/P	1
12	ASG00034	MAST 2.0M	1
12	ASG00035	MAST 2.25M	1
12	ASG00036	MAST 2.5M	1
13	CMH00049	TOP LINK PIN STEPPED	1
14	CRA00030	RAM HYD TOP LINK 22"	1
14	CRA00011	RAM HYD TOP LINK 24"	1
14	CRA00017	RAM HYD TOP LINK 26"	1
14	CSE00010	SEAL KIT HYD TOP LINKS	1
14	ASG00037	QUICK ATTACH BRACKET	1
16	ACH00224	CAT 2 QUICK FIT BAR	1
17	CFA00124	NUT M12 NYLOC	1
18	ASG00038	HIGH LIFT FRAME STAND 2.0M	1
18	ASG00039	HIGH LIFT FRAME STAND 2.25,2.5	1
19	CFA00034	BOLT M12X90 Z/P	1
20	CFA00272	BOLT M12X50 Z/P	2
22	CSG00011	SPRING PULL 3.5X28X135T	2
23	CMH00037	TOPLINK PIN 3/4" Z/P	1
24	CFA00136	WASHER FLAT 3/4" Z/P	1
25	CRA00002	RAM SINGLE STAGE - 2M HLF	1
25	CRA10002	RAM ROD HLF SINGLE STAGE 2M HLF	1
25	CSE00002	SEAL KIT HLF 2M SINGLE STAGE	1
25	CRA00062	RAM 2 STAGE 2.25M HLF -MK2	1
25	CRA10062	RAM ROD 2.25 HLF SINGLE STAGE	1
25	CRA00024	RAM 2 STAGE, 2.5M HLF	1

No.	Part No	Description	Qty
25	CRA10024	RAM ROD HLF 2 STAGE 2.5M	1
25	CSE00024	SEAL KIT HLF 2 STAGE	1
25	CVA00012	CONTROL VALVE 4 BANK HLF	1
25	CTP00014	VALVE POCKET 100MM LONG	1

www.edanex.pl

**Decals (700)**



1



2



3



4



5



6



7



8

www.edanex.pl

No.	Part No	Description	Qty
0	CST00009	DECAL KIT SHEARGRAB	1
1	CST00097	DECAL	0
2	CST00096	DECAL	0
3	CST00055	DECAL	0
4	CST00098	DECAL	0
5	CST00657	DECAL	0
6	CST00060	DECAL	0
7	CST00091	DECAL	0
8	???	DECAL	0

No.	Part No	Description	Qty
-----	---------	-------------	-----

[www.edanex.pl](http://www.edanex.pl)