

McHale *ENGINEERING*



QUALITY

I.S. EN ISO 9001:2008

NSAI Certified

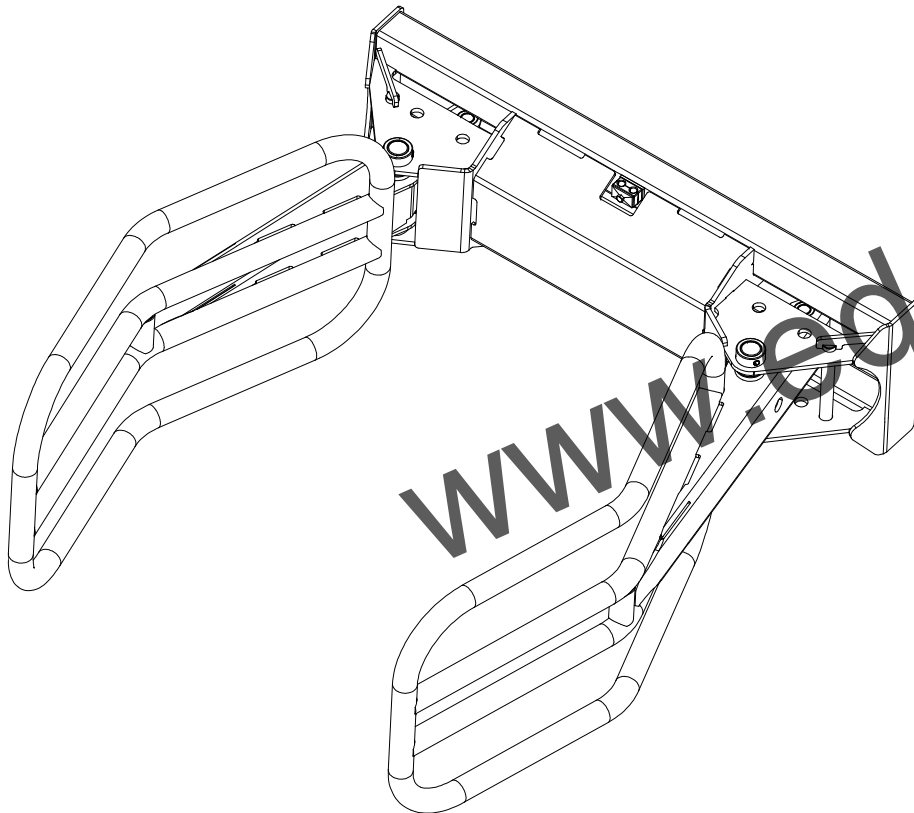

www.edanex.pl

R5

Spare Parts Book

McHale Engineering,
Castlebar Rd, Ballinrobe,
Co. Mayo, Ireland.
Tel: +353 94 9520300
Fax: +353 94 9520356
Email: sales@mchale.net
Website: www.mchale.net

www.edanex.pl

This page is intentionally left blank

Introduction

The **McHale R5** which you have purchased has been developed through years of constant research and development. Given proper care and attention the **R5** will give years of reliable and dependable performance. However it is important that the operators manual is read and fully understood to achieve this, **before** the machine is operated. As part of this philosophy it is vital to use only **genuine McHale** replacement parts, as these are manufactured to the same high standard as the original machine. These may be obtained through your **McHale** dealer.

If any part of this manual is not fully understood, please contact your **McHale** dealer who will be able to answer any questions or queries that you might have. It is important to quote the machine serial number when requiring spare parts or technical assistance. Space is provided below to record the machine details:

Serial number:	
Year of manufacture:	
Date of delivery:	

If you require further copies of this spare parts manual please quote part number CLT00352

Note: Parts described as left and right are done so according to the direction that the machine normally travels in.

Note: Due to a policy of continuous product development and improvement *McHale Engineering* reserve the right to alter machine specifications without prior notice.

Contents

Section	Document No	Section	Document No
R5 Chassis (484)	SPD00484		

www.edanex.pl

www.edanex.pl

This page is intentionally left blank

Chassis (484)

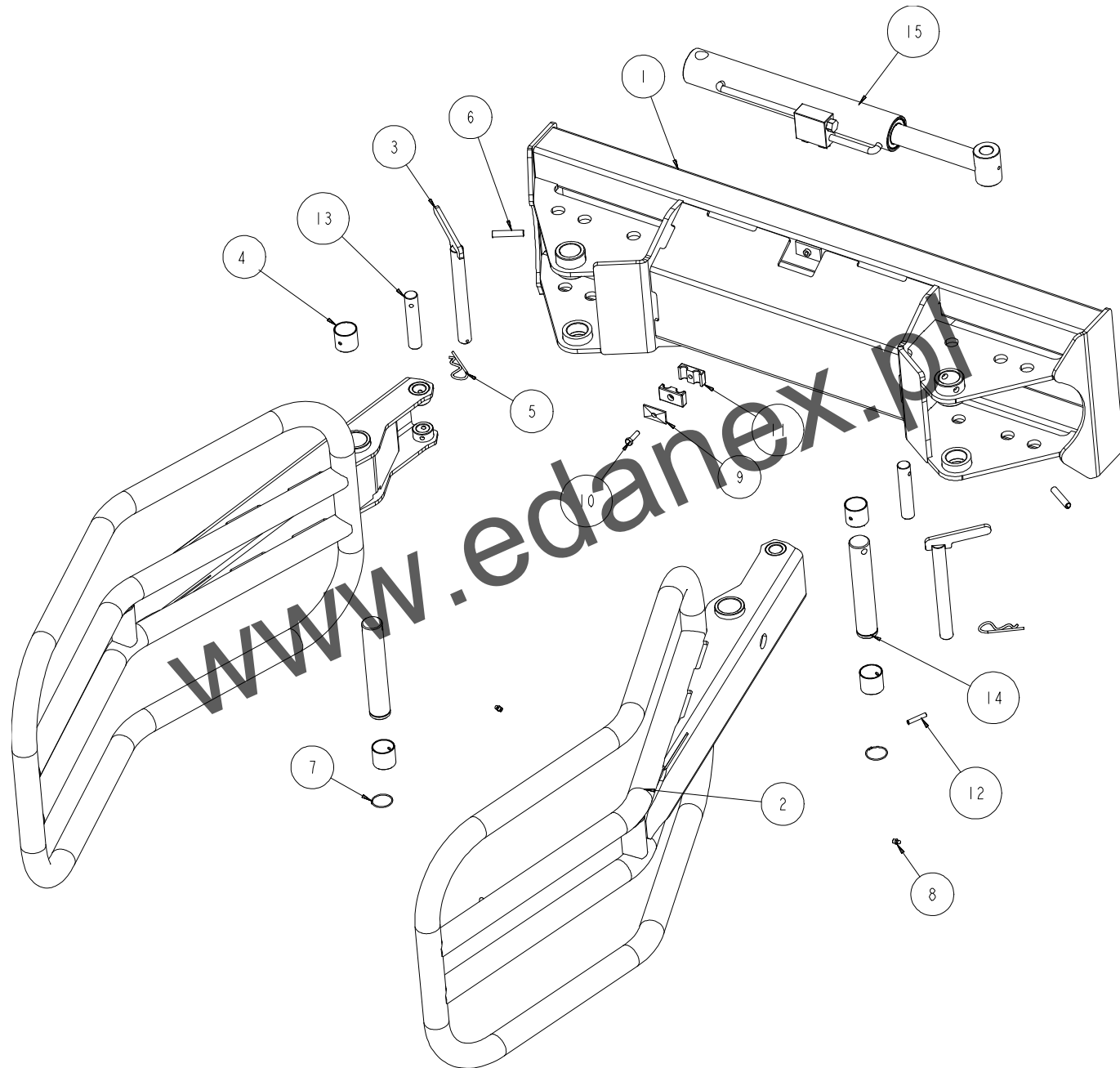

No.	Part No	Description	Qty
1	ACH02222	SOFT HANDS BACK WELD ASSY	1
2	ACH02224	SOFT HANDS WELD ASSY	2
3	ALA00180	BALE HANDLER LOCK PIN	2
4	CBR00018	BEARING GLACIER PM 4040 DX	4
5	CFA00004	R-CLIP 4MM	2
6	CFA00110	ROLL PIN 12X60 MIKALOR ONLY	2
7	CFA00113	SNAP RING 40MM	2
8	CFA00118	GREASE NIPPLE M8X1.25 STRAIGHT	2
9	CFA00183	HOSE CLAMP COVER PLATE 14-18MM	1
10	CFA00316	BOLT M8X30 Z/P	1
11	CFA00374	14MM HOSE CLAMP	2
12	CFA00380	ROLL PIN 8X40 Z/P	2
13	CMH01047	PIN 25X125 8MM C HOLE	2
14	CMH01052	PIN 40X225	2
15	CRA40026	RAM 70X40 C/W CHECK VALVE	1
15a	CSE40026	SEAL KIT CRA40026 70MM RAM	1
15b	CVA00035	CTE CHECKVALVE MCHALE 20	1

No.	Part No	Description	Qty
-----	---------	-------------	-----

www.edanex.pl